



# USRA 0-8-0 Steam Locomotive

## OPERATOR'S MANUAL

### Compatibility

This engine is available in 2-rail and 3-rail Versions and will operate on any O-31 Gauge track system (3-rail), 31" radius (2-rail) including M.T.H.'s RealTrax and ScaleTrax or traditional tubular track. It is also compatible with most AC and DC transformers. See page 24 for a list of compatible transformers and wiring instructions.



Freight Yard Sound

PLEASE READ BEFORE USE AND SAVE

# Table of Contents

|  |    |
|--|----|
| Configuring Locomotive for 2-Rail or 3-Rail Operation.....             | 3  |
| Installing/Removing 3-Rail Pickup Rollers.....                         | 3  |
| Ensuring Proper Power to Track Polarity.....                           | 3  |
| Changing Track Polarity Inside the Locomotive.....                     | 4  |
| Set Up Checklist.....  | 5  |
| Lubrication.....   | 5  |
| Priming the Smoke Unit.....  | 5  |
| Placing the Engine on the Track.....                                   | 6  |
| Checking the Battery.....  | 6  |
| Basic Operation.....   | 7  |
| Activating Features.....   | 7  |
| Manual Volume Control.....   | 8  |
| Proto-Sound 2.0 Operating Instructions.....                            | 9  |
| Activating Proto-Sound 2.0 Conventional Mode Features.....             | 9  |
| Freight Yard Sounds (FYS)/ Passenger Station Announcements (PSA).....  | 10 |
| Proto-Coupler® Operation.....  | 11 |
| Speed Control.....   | 12 |
| Locking Locomotive Into A Direction.....                               | 13 |
| Reset To Factory Default.....  | 13 |
| Automatic Sound Effects.....   | 13 |
| Maintenance.....   | 14 |
| Lubricating and Greasing Instructions.....                             | 14 |
| Cleaning The Wheels, Tires and Track.....                              | 15 |
| Traction Tire Replacement Instructions.....                            | 16 |
| Headlight Replacement Instructions.....                                | 16 |
| Self Charging Battery Back-Up.....                                     | 18 |
| ProtoSmoke® Unit Operation.....  | 19 |
| Troubleshooting Proto-Sound® 2.0 Problems.....                         | 21 |
| Transformer Compatibility and Wiring Chart.....                        | 24 |
| Additional Features Accessible with the DCS Remote Control System..... | 25 |
| Service & Warranty Information.....                                    | 26 |

**CAUTION: ELECTRICALLY OPERATED PRODUCT:**

Not recommended for children under 10 years of age. M.T.H. recommends adult supervision with children ages 10 - 16. As with all electric products, precautions should be observed during handling and use to reduce the risk of electric shock.

**WARNING:** When using electrical products, basic safety precautions should be observed, including the following: Read this manual thoroughly before using this device.

- M.T.H. recommends that all users and persons supervising use examine the hobby transformer and other electronic equipment periodically for conditions that may result in the risk of fire, electric shock, or injury to persons, such as damage to the primary cord, plug blades, housing, output jacks or other parts. In the event such conditions exist, the train set should not be used until properly repaired.
- Do not operate your layout unattended. Obstructed accessories or stalled trains may overheat, resulting in damage to your layout.
- This train set is intended for indoor use. Do not use if water is present. Serious injury or fatality may result.
- Do not operate the hobby transformer with damaged cord, plug, switches, buttons or case.

This product may be protected by one or more of the following patents: 6,019,289; 6,280,278; 6,281,606; 6,291,263; 6,457,681; 6,491,263; 6,604,641; 6,619,594; 6,624,537; 6,655,640.

# Configuring Locomotive for 2-Rail or 3-Rail Operation

## Installing/Removing 3-Rail Pickup Rollers

Both 2-Rail and 3-Rail versions of this locomotive can be configured to operate on either 2-rail or 3-rail track by removing or adding the center rail pickups. 3-rail rack operation requires the pickups, 2-rail track operation does not. The pickups are factory installed on 3-rail versions and packaged separately in the locomotive box for 2-rail versions. Each pickup roller installs with a single phillips screw

## Configuring for 2-Rail or 3-Rail Power Input

Once you have configured the engine for 2-rail or 3-rail operation, you must manually select the power input switch located on the bottom of the tender for 2 rail operation as seen in Figure 1.

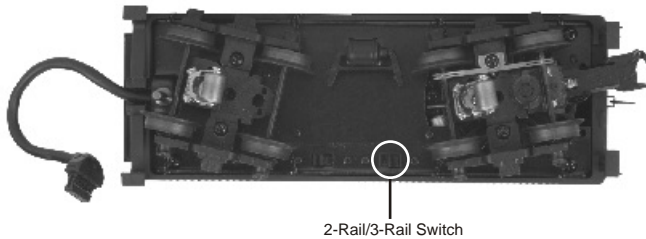

Figure 1

## Ensuring Proper Power to Track Polarity

For 2-rail DCS operation, it is important that the polarity from the transformer to the engine is properly configured. Correct polarity can be accomplished by ensuring that the wiring from the TIU to the track and orientation of the locomotive when sitting on the track follows the illustration in Figure 2.

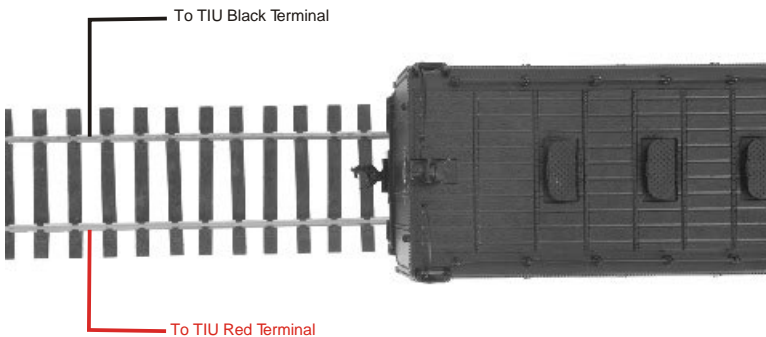
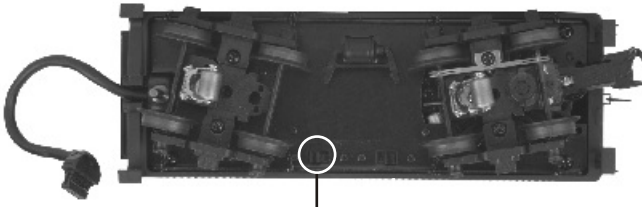

Figure 2

# Changing Track Polarity Inside the Locomotive

Failing to properly configure the polarity will result in the locomotive starting in reverse instead of forward or not receiving the DCS signal. Should this occur, it is not necessary to swap the wires from the transformer to the track or reverse the locomotive's orientation on the track itself. Instead, simply slide the polarity switch located on the tender as seen in Figure 3.



DCS Polarity Switch

(The DCS Polarity Switch should be moved forward when the Red Terminal of the TIU is connected to the right hand rail and to the rear when the Red Terminal is connected to the left hand rail.)

*Figure 3*

# Set Up Checklist

- Lubricate the locomotive
- Prime the smoke unit
- Check to see whether the battery needs to be charged for full sound effects
- Apply power to run as described in the Basic Operating Section of this manual

## Lubrication

You should lubricate the engine to prevent it from squeaking. Use light household oil and follow the lubrication points marked “L” in Fig. 4. Do not over-oil. Use only a drop or two on each pivot point.

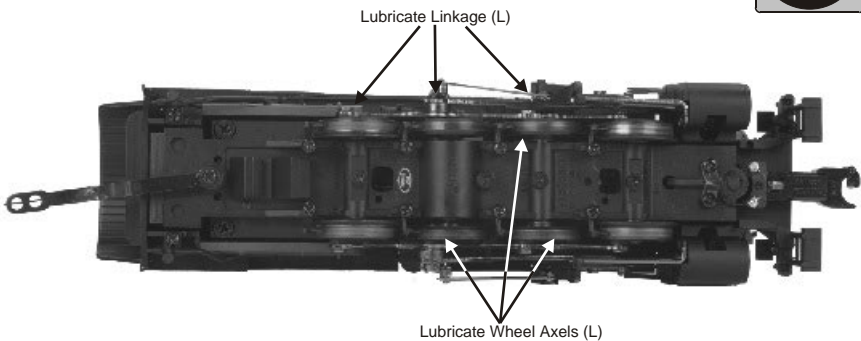

Figure 4. Lubrication Points on the Locomotive

## Priming the Smoke Unit

When preparing to run this engine, add 15-20 drops of smoke fluid through the smokestack. We recommend M.T.H. ProtoSmoke, Seuthe, LGB, or LVTS fluids. Do not overfill the unit or the fluid may leak out and coat the interior engine components.

If you choose not to add the fluid (or have already added the fluid but choose to run smoke-free), turn off the smoke unit switch located under the water hatch on the tender (see Fig. 5). Failure either to add fluid to the unit or to turn it off may damage the smoke unit heating element and/or wicking material.

 Running the engine without a primed smoke unit may cause damage



Figure 5. Smoke Unit Switch Location

## Placing The Engine on the Track

Place the engine on the track, then insert the reverse unit plug that extends out of the tender into the receptacle at the back of the boiler cab (Figure 6. **WARNING: DO NOT CONNECT THIS ENGINE TO A TENDER FROM ANOTHER ENGINE; IT MAY CAUSE SERIOUS DAMAGE.** Look at the bottom of the engine and tender where each will have a color-coded stamp. If they match you may connect those two pieces; if not, don't.

Connect the draw bar between the engine and tender. The draw bar hole located farthest from the tender is for applications such as display. The second hole is for normal operation on the track.

At this point, you are ready to begin running your engine.



*Figure 6*

## Checking the Battery

You may find, if your locomotive was built several months before you set it up, that the rechargeable battery has run down and needs to be charged before operating. If you notice that the sounds are garbled, test and charge the engine as described in the "Self-Charging Battery Back-Up" on page 19.

# Basic Operation

The Throttle knob controls how fast your train will travel. Turn the throttle knob up ½-way, until the engine lights shine bright. Put the engine into motion by pressing the Direction button on your transformer once. (hold it for approximately 1 second)

If the engine does not begin to move as soon as you firmly press the Direction button, you may not have sent enough voltage to the track to make the train move. Turn the throttle up a bit higher until the train begins to move.

## Activating Features

**Throttle** - To increase or decrease track voltage, and therefore train speed, turn the throttle control knob. Turning clockwise will increase voltage and speed, while turning counterclockwise will decrease voltage and speed. The engine will maintain the speed you set after you release the throttle until you turn it again to change the voltage and speed.

**Bell** - To sound the bell, in an engine equipped with a bell firmly press and release the Bell button. To turn the bell off, press and release the Bell button again. The bell will continue to ring from the time you turn it on until you press and release the button again to turn it off.

**Horn/Whistle** - To sound the horn/whistle, firmly press the horn/whistle button. The horn or whistle will sound for as long as you continue to depress the button. It will stop when you release the button.

**Direction** - Your train is programmed to start in neutral. The train will always cycle neutral-forward-neutral-reverse with each press and release of the direction button. The engine is programmed to restart in neutral each time the track voltage is turned off for 25 seconds or more.

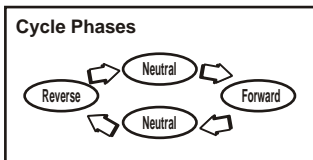

# Manual Volume Control

To adjust the volume of all sounds made by this engine, turn the master volume control knob located next to the fuel tank clockwise to increase the volume and counter-clockwise to decrease the volume.

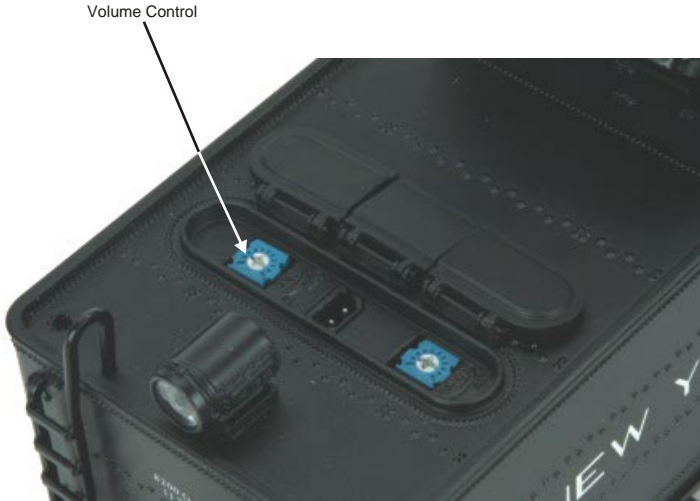

*Figure 7. Manually Adjusting The Volume*



# Proto-Sound 2.0 Operating Instructions

This manual contains the operating instructions for Proto-Sound 2.0 in conventional mode only. Instructions for accessing DCS command mode features accompany the DCS Remote Control System equipment.

## Activating Proto-Sound 2.0 Conventional Mode Features

Proto-Sound 2.0 features are activated by sequences of Bell and Horn button pushes described below. Please read the full descriptions of each feature before using it. To use these buttons to activate features rather than to blow the horn or ring the bell, you should tap the buttons very quickly with a ½-second pause between button presses. You may need to practice your timing to make this work smoothly.

| Timing Chart                  |              |                         |              |                         |
|-------------------------------|--------------|-------------------------|--------------|-------------------------|
| Press Whistle Short & Firm    | ½ Sec. Pause | Press Bell Short & Firm | ½ Sec. Pause | Press Bell Short & Firm |
| Total Time Lapse: 1 ½ Seconds |              |                         |              |                         |

| Feature to Be Activated                  | Button Code:                                |
|--|---|
| Freight Yard or Passenger Station Sounds | 1 Bell, 2 Horn/Whistles                     |
| Fire the Rear Coupler                    | 1 Bell, 3 Horn/Whistles                     |
| Fire the Front Coupler                   | 1 Bell, 4 Horn/Whistles                     |
| Speed Control On/Off                     | 1 Horn/Whistle, 2 Bells (from Neutral only) |
| Lock into a Direction                    | 1 Horn/Whistle, 3 Bells                     |
| Reset to Factory Defaults                | 1 Horn/Whistle, 5 Bells (from Neutral only) |

## Freight Yard Sounds (FYS) or Passenger Station Announcements (PSA):

Your engine is equipped with a sound package of either freight yard or passenger station sounds that you can play. Each sequence described below will play as long as it is left on, randomly generating sounds, but be sure to allow approximately 30 seconds between the button pushes described below to allow the FYS/PSA sufficient time to run through each sequence.

- To cue the sound system to play the FYS/PSA, quickly but firmly tap the Bell button once followed by 2 quick taps of the Horn/Whistle button while the engine is moving. Tap the buttons quickly but allow approximately ½ second between each press
- Press the Direction button once to stop the engine. This will trigger the first sequence of FYS/PSA. The reverse unit is temporarily disabled so that the train will not move as you use the Direction button to trigger the sounds, and Proto-Sound 2.0 has disabled operator control over the Horn/Whistle and Bell buttons until the full FYS/PSA sequence is complete.
- After waiting about 30 seconds for that sequence to run, press the Direction button again to trigger the second sequence of FYS/PSA.
- After about 30 seconds, press the Direction button again to trigger the third FYS/PSA sequence.
- Again, after allowing about 30 seconds for that sequence to run, press the Direction button. FYS/PSA will continue, and within a few seconds, the engine will start and move out on its own at the current throttle setting, in the same direction it was traveling when you began the sequence. Once the bell turns off, the operator regains control of the transformer's Bell and Horn/Whistle buttons and can ring the bell or blow the horn/whistle as usual.

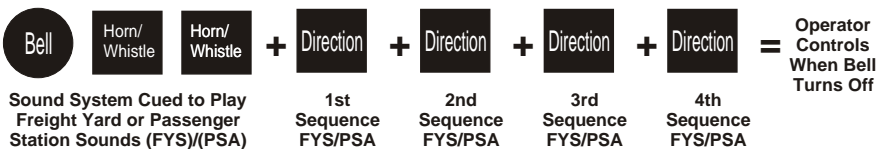

## Tips on Using FYS/PSA

- You can terminate FYS/PSA at any time by turning off power to the track for 15 seconds.
- You do not have to be in Forward to use FYS/PSA. At the conclusion of the full sequence, the train will pull away from the station in whatever direction you were going when you activated the feature.
- You can use FYS/PSA even if you are double-heading with another engine. If the second engine is not equipped with Proto-Sound 2.0, you must remember not to leave the throttle at a high voltage level once you have stopped the engine to run the FYS/PSA. Otherwise, the engine without FYS/PSA will begin vibrating on the track as its motors strain to move the train, since they cannot be automatically disabled during the FYS/PSA cycle (or if an original Proto-Sound engine, FYS/PSA are triggered differently and that engine's motor-disable feature will not be active when you run FYS/PSA in Proto-Sound 2.0).
- FYS/PSA can be triggered from Neutral. It will operate the same as if triggered while in motion except that, at the conclusion of the FYS/PSA, the engine will depart in the next direction of travel, as opposed to the direction it was traveling before entering Neutral.

## Proto-Coupler® Operation

This locomotive is equipped with one or more coil-wound Proto-Couplers for remote uncoupling action. Because Proto-Couplers are controlled through the Proto-Sound 2.0 microprocessor, they do not require an uncoupling track section or modification to your layout to function. You can fire a coupler from neutral or while in motion. Use the code shown below (and in the chart on p. 7) to fire the coupler(s).

Rear Coupler:

To fire the rear coupler, quickly tap the Bell button once followed by three quick taps of the Horn button, allowing approximately ½ second to lapse between each quick button press. The sound of the liftbar and air line depletion will play, and the knuckle will be released.



## Front Coupler:

To fire the front coupler (if your engine has one), quickly tap the Bell button once followed by four quick taps of the Horn button, allowing approximately 1/2 second to lapse between each quick button press. The sound of the liftbar and air line depletion will play, and the knuckle will be released.



## Speed Control

M.T.H. engines equipped with Proto-Sound 2.0 have speed control capabilities that allow the engine to maintain a constant speed up and down grades and around curves, much like an automobile cruise control. You can add or drop cars on the run, and the engine will maintain the speed you set.

While the engine is programmed to start with the speed control feature activated, you can opt to turn it off. This means the engine's speed will fall as it labors up a hill and increase as it travels downward. It is also affected by the addition or releasing of cars while on the run. Because the engine will run more slowly at a given throttle voltage when speed control is on than when it is off, you should adjust the throttle to a lower power level for operation with speed control off to avoid high-speed derailments. When speed control is off, the volume will drop to allow for better low voltage operation.

To turn speed control on and off, put the engine in neutral, then quickly tap the transformer's Horn button one time then quickly tap the Bell button two times, allowing approximately 1/2 second to lapse between each quick button press. Two horn blasts will indicate that the engine has made the change. Repeat the 1 horn, 2 bells code to return it to the other condition. You will want to do this during the initial neutral upon start-up if you ever couple this engine to another engine that is not equipped with speed control to avoid damaging the motors in either engine. Each time you shut down the engine completely, it will automatically turn speed control on.



# Locking Locomotive Into A Direction

You can lock your engine into a direction (forward, neutral, or reverse) so that it will not change directions. To do this, put the engine into the direction you want (or into neutral to lock it into neutral), run it at a very slow crawl (as slowly as it will move without halting), and quickly but firmly tap the Horn button once followed by three quick taps of the Bell button, allowing approximately ½ second to lapse between each quick button press. Two horn blasts will indicate that the engine has made the change. The engine will not change direction (including going into neutral) until you repeat the 1 horn, 3 bells code to return the engine to its normal condition, even if the engine is kept without power for extended periods of time.



# Reset To Factory Default

To override the settings you currently have assigned to the engine and reset it to its factory defaults, while in Neutral tap the Horn button quickly once, followed by five quick taps of the Bell button, allowing approximately ½ second to lapse between each quick button press. Two horn blasts will indicate that the engine has made the change.



# Automatic Sound Effects

Certain Proto-Sound 2.0 sound effects automatically play in programmed conventional mode conditions:

- Squealing Brakes play any time the engine's speed decreases rapidly.
- Cab Chatter plays at random intervals when the engine idles in neutral.
- Engine Start-up and Shut-down sounds play when the engine is initially powered on or is powered off for five seconds or more.

# Maintenance

## Lubricating and Greasing Instructions

The engine should be well oiled and greased in order to run properly.

You should regularly lubricate all side rods, linkage components and pickup rollers to prevent them from squeaking. Use light household oil and follow the lubrication points marked “L” in Fig 8. Do not over-oil. Use only a drop or two on each pivot point.

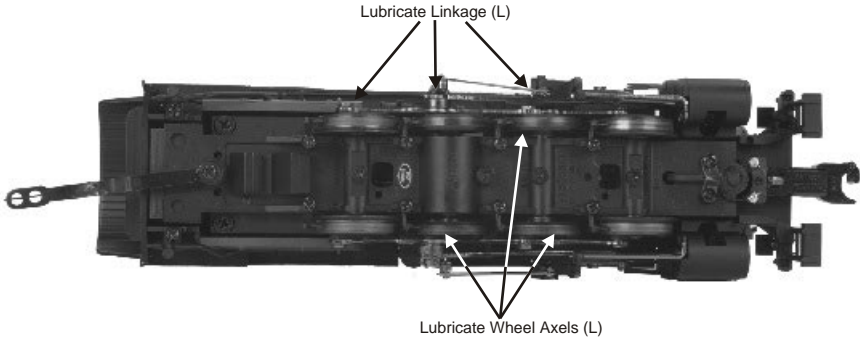

*Figure 8. Lubrication Points on the Locomotive*

The locomotive's internal gearing was greased at the factory and should not need additional grease until after 50 hours of operation or one year, whichever comes first. To access the gear box and axles, do the following:

1. Turn the engine upside down.
2. Remove the Phillips screws (marked “GREASE”) located at each set of wheels and under pickup rollers (Fig. 9).
3. Use a grease tube dispenser to put a small amount (approx. 1-2 ml.) of lithium-based grease into the screw holes.
4. Replace the screws.

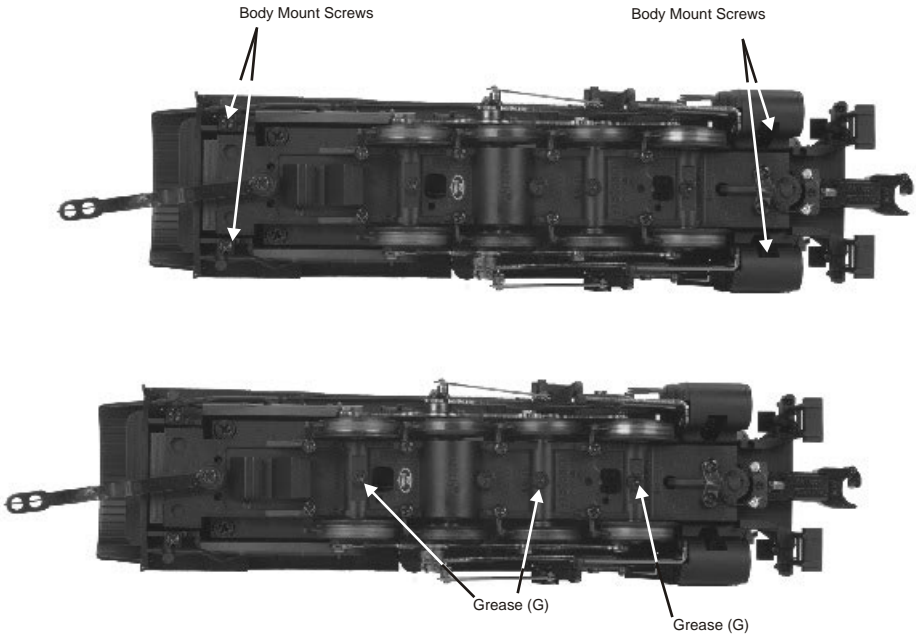

*Figure 9. Removing the Body and Lubricating the Grease Points*

## Cleaning the Wheels, Tires and Track

Periodically check the locomotive wheels and pickups for dirt and buildup which can cause poor electrical contact and traction as well as prematurely wear out the neoprene traction tires.

Wheels and tires can be cleaned using denatured (not rubbing) alcohol applied with a cotton swab.



## Traction and Tire Replacement Instructions

Your locomotive is equipped with two neoprene rubber traction tires on the rear set of flanged drivers. While these tires are extremely durable, you may need to replace them at some point.

1. Remove the side rods from the wheels in order to slip the new tire over the grooved drive wheel. Make sure to note the position of all rods before removing.
2. Make sure the old tire has been completely removed from the groove in the drive wheel, using a razor blade or small flathead screwdriver to pry away any remains.
3. Slip the new tire onto the wheel. You may find it useful to use two small flathead screwdrivers to stretch the tire over the wheel.
4. If you twist the tire while stretching it over the wheel, you will need to remove and reinstall the tire. Otherwise your engine will wobble while operating.
5. Make sure the tire is fully seated inside the groove. Use a razor blade to trim away any excess tire that doesn't seat itself inside the groove properly.
6. Reinstall the side rods in the same positions as noted. Failure to align rods may cause binding or damage to the drive system.

One set of replacement tires is packaged with your model. Additional sets are available directly from the M.T.H. Parts Department (phone: 410-381-2580; e-mail: [parts@mth-railking.com](mailto:parts@mth-railking.com); mail: 7020 Columbia Gateway Drive, Columbia MD 21046-1532).

## Headlight Replacement Instructions

The locomotive's lights are controlled by a constant voltage circuit in the engine. They are easy to remove and replace when they burn out. See the diagrams and directions below for instructions on accessing and replacing the light bulbs in this locomotive.

You can obtain replacement bulbs directly from the M.T.H. Parts Department (order online: [www.mth-railking.com](http://www.mth-railking.com), e-mail: [parts@mth-railking.com](mailto:parts@mth-railking.com); mail: 7020 Columbia Gateway Drive, Columbia MD 21046-1532, FAX: 410-381-6122).

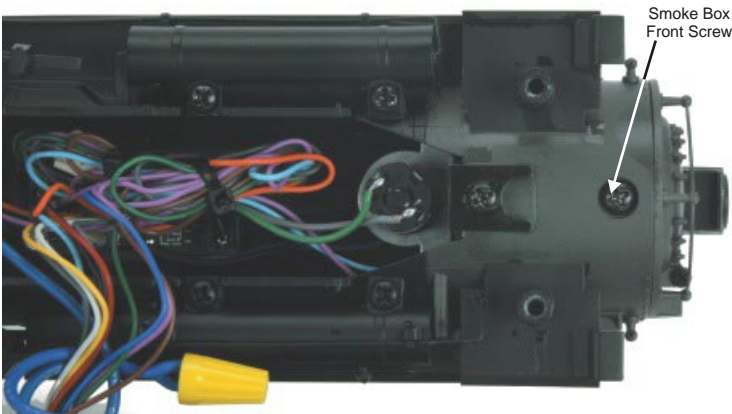

*Figure 10*



### To Replace Headlight:

1. Remove the body mount screws as shown in Fig 8 and separate the boiler from the chassis.
2. Remove the screw attaching the smokebox front and pull the smokebox front from the boiler shell. (Fig 11)
3. Gently pull the bulb from the headlight shell and separate the blue connector inside the smokebox area. (Fig 12)
4. Insert the replacement bulb and the smokebox front being careful not to pinch any of the wires.
5. Place the boiler back on the chassis. Make sure that no wires are pinched. Then replace the body mount screws.



*Figure 11*

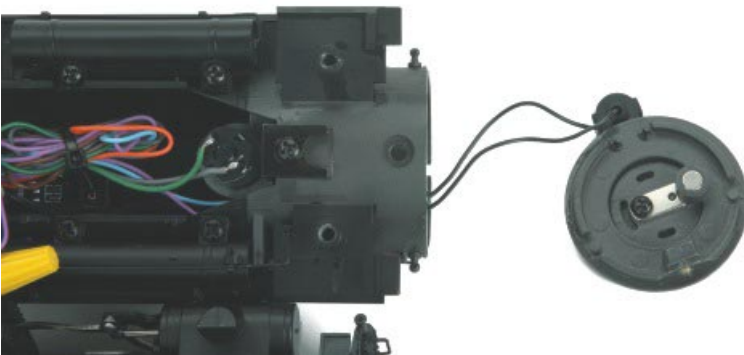

*Figure 12*

# Self Charging Battery Back-up

The special NiCad 2.4v self-charging battery recharges continuously during train operation and should last for up to five years. The battery is a dry battery that should not leak or cause any damage to your engine. Depending upon when your engine was built, it may need to be charged right out of the box. If engine sounds seem distorted or garbled at low voltages or become silent when power from the transformer is turned off, test the battery to determine whether it should be recharged or replaced.

**Test:** Put the engine in neutral and leave the track voltage at 10-12 volts (high enough for the lights to shine brightly) for 15 minutes.

**Recharge:** If the sounds are improved at the end of the 15-minute test charge, the battery charge has run down and can be recharged. There are a number of ways you can do this:

- Leave the engine in neutral with track voltage at 10-12 volts for 6-7 hours so the battery can fully recharge (if your engine has a smoke unit, be sure it is turned off).
- Use M.T.H.'s battery recharger (sold separately) that plugs into a wall outlet and a special port under the engine to recharge the battery overnight without leaving it on the track.

**Replace:** If the sounds are not improved at the end of the 15-minute test charge, it is time to replace the battery. Available through M.T.H. Parts.

**DO NOT** substitute alkaline batteries for these NiCad batteries. Using alkaline batteries in this system can result in damage to the PS 2.0 circuit board and/or the batteries.

**\*\*Do not use alkaline batteries for testing or checking purposes for the 3-Volt PS2 boards. Using alkaline batteries will damage the 3-Volt battery charging circuit.\*\***

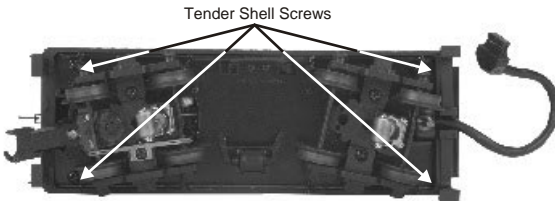

Figure 13



Figure 14

# ProtoSmoke® Unit Operation

This Premier steam locomotive contains a self-powered smoke unit that outputs smoke through the smokestack on the roof of the engine. The smoke unit is essentially a small heating element and wick that soaks up and then heats a mineral oil-based fluid that emits a harmless smoke. The smoke is then forced out of the stack by a small electric fan. Smoke volume is controlled by the Proto-Sound 2.0 system.

With a few easy maintenance steps, you should enjoy trouble-free smoke unit operation for years.

When preparing to run this engine, add 15-20 drops of smoke fluid through the smokestack (see Fig. 15). We recommend M.T.H. ProtoSmoke, Seuthe, LGB, or LVTS fluids. Do not overfill the unit or the fluid may leak out and coat the interior engine components.

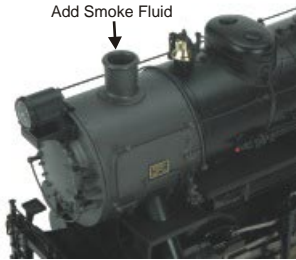

Figure 15



Figure 16

If you choose not to add the fluid (or have already added the fluid but choose to run smoke-free), turn off the smoke unit switch located under the water hatch on the tender (see Fig. 16). Failure either to add fluid to the unit or to turn it off may damage the smoke unit heating element and/or wick material.

When the smoke output while running the engine begins to diminish, add another 10-15 drops of smoke fluid or turn the smoke unit off.

When storing the unit for long periods of time, you may want to add about 15 drops of fluid to prevent the wick from drying out.

After removing the engine from storage, add another 25 drops of fluid, letting the wick soak up the fluid for 15 minutes prior to operation.

If you experience poor or no smoke output when the smoke unit is on and has fluid, check the wick to see if it has become hard, blackened, and unabsorbent around the heating element. To remove the smoke unit you will first have to remove the boiler shell (by removing the body mounting screws shown in Fig 9 on pg. 15), board and bracket that block the smoke unit assembly from being accessed. To do this, follow these instructions:

1. Unplug the two wiring harnesses from the board mounted to the inside of the boiler and behind the smoke unit.
2. Remove the two screws securing the smoke unit inside the shell as seen in Fig 17.
3. With the board free of the mounting screws, slide the assembly out of the boiler as seen in Fig. 18.

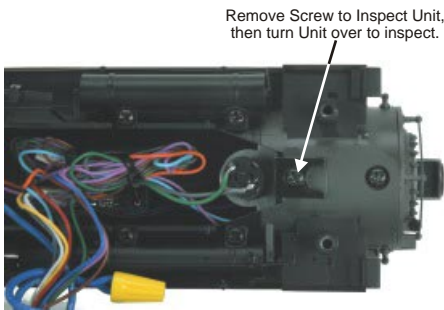

*Figure 17*

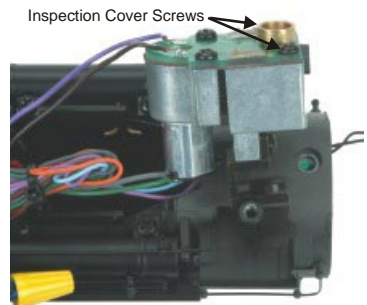

*Figure 18*

4. Once the unit is freed, remove the inspection cover (Fig. 18). Inspect the wick; if it is darkly discolored and hard, it should be replaced.

Replacement parts and wick replacement instructions are available directly from the M.T.H. Parts Department phone: 410-381-2580; e-mail: [parts@nth-railking.com](mailto:parts@nth-railking.com); 7020 Columbia Gateway Drive, Columbia MD 21046-1532

# Troubleshooting Proto-Sound® Problems

Although Proto-Sound 2.0 has been designed and engineered for ease of use, you may have some questions during initial operation. The following table should answer most questions. If your problem cannot be resolved with this table, contact M.T.H. for assistance (telephone: 410-381-2580; fax: 410-423-0009; service@mth-railking.com, 7020 Columbia Gateway Drive, Columbia MD 21046-1532).

| <b>Starting Up</b>  | <b>Remedy</b>  |
|---|--|
| When I first turn the power on, the engine will not begin to run. I have to turn the throttle off and then on again to get the engine to operate. | This is normal behavior. To prevent accidental high-speed start-ups, Proto-Sound 2.0 is programmed to start up in neutral anytime track power has been turned off for several seconds. |
| <b>Whistle/Horn</b>   | <b>Remedy</b>  |
| When I press the whistle/horn button, the bell comes on instead.  | Reverse the transformer leads.   |
| I can't get the horn to blow when I press the whistle button.   | You may be pressing the button too quickly. Try pressing the whistle/horn button more slowly, taking approximately one full second to fully depress the button.                        |
| <b>Bell</b>   | <b>Remedy</b>  |
| When I press the whistle button, the bell sounds.   | Reverse the transformer leads.   |
| I can't get the bell to ring when I press the bell button.  | You may be pressing the button too quickly. Try pressing the bell button more slowly, taking approximately one full second to fully depress the button.                                |
| The bell won't work on a separate bell button.  | Check the wiring of the separate button.   |
| <b>Coupler</b>  | <b>Remedy</b>  |
| When I try to fire the coupler, FYS starts.   | You are waiting too long between whistle button presses.   |
| The Proto-Coupler won't let the engine uncouple on the fly.   | Try lubricating the coupler knuckle with a dry graphite lubricant. Do NOT use oil.   |
| The coupler does not fire or stay coupled.  | The coupler needs to be cleaned. Wipe with denatured alcohol (not rubbing alcohol) and let dry.  |

| <b>Cab Chatter</b>   | <b>Remedy</b>   |
|--|---|
| Sometimes the Cab Chatter sounds don't play.   | Cab Chatter plays only in neutral at random intervals.  |
| <b>Lock-out</b>  | <b>Remedy</b>   |
| I can't get the engine to run after I power up the transformer. It sits              | The engine is locked into the neutral position. Follow the procedure in the "Lock into a Direction" section.  |
| The engine won't lock into forward, neutral, or reverse.                             | Engine speed must be below 10 scale mph (approx. 10 volts or less in conventional mode).  |
| <b>Volume</b>  | <b>Remedy</b>   |
| The sounds seem distorted, especially when the whistle or bell is activated.         | Proto-Sound 2.0 volume is set too high. Turn the volume control knob on the bottom of the chassis counter-clockwise to reduce the volume.   |
| <b>Battery</b>   | <b>Remedy</b>   |
| The engine will not leave the initial neutral setting.                               | Check to be sure the battery is installed and fully charged. See the "Self-Charging Battery Back-Up" section.   |
| I get no sounds when the engine shifts between directions.                           | The battery may be dead or need to be charged. See the "Self-Charging Battery Back-Up" section.   |
| After I turn off my transformer, my engine continues to make sounds before quitting. | Proto-Sound 2.0 is designed to continue to sound for a few seconds after power to the track has been shut off.  |
| <b>FYS</b>   | <b>Remedy</b>   |
| The FYS sounds occasionally repeat themselves.                                       | Proto-Sound 2.0 has a built-in random number generator that randomly selects each sound clip to play. Because there are a limited number of sound clips available in each FYS sequence, it is probable that some of these sound clips will be repeated from time to time. |

| FYS  | Remedy  |
|--|---|
| Once in FYS, the engine doesn't go into reverse.   | So that FYS effects can be as realistic as possible, Proto-Sound 2.0 disables the reversing unit whenever FYS is enabled. This way the engine remains still at its stop as the operator cycles through the FYS sequences. |
| When the FYS enters its last sequence the bell automatically comes on.   | FYS is programmed to start ringing the bell at that point. After approximately 12 seconds it will automatically turn off.   |
| When FYS is enabled, pressing the whistle and bell buttons has no effect.  | Because FYS must control various effects in each sequence, Proto-Sound 2.0 takes control of these sound effects until you exit FYS.   |
| I push the direction button but the next sound clip in the sequence does not play or the engine does not come out of FYS after fourth press of the direction button. | Each FYS clip must play for approx. 30 seconds before FYS will advance to the next step in the FYS cycle. Wait at least 30 seconds in each FYS sound clip before pressing the direction button.                           |

# Transformer Compatibility and Wiring Chart

Proto-Sound 2.0 is designed to work with most standard AC transformers. The chart below lists the many compatible transformers. Note that many of the operational commands described in these instructions require a bell button, so if your transformer does not have its own bell button, you should consider adding one to get the full benefit of the system. In addition, the chart details how the terminals on these transformers should be attached to your layout.

| Transformer Model                     | Center Rail            | Outside Rail          | Min/Max. Voltage | Power Rating        | Transformer Type |
|---------------------------------------|------------------------|-----------------------|------------------|---------------------|------------------|
| MTH Z-500                             | Red Terminal           | Black Terminal        | 0-18v            | 50-Watt             | Electronic       |
| MTH Z-750                             | Red Terminal           | Black Terminal        | 0-21v            | 75-Watt             | Electronic       |
| MTH Z-1000                            | Red Terminal           | Black Terminal        | 0-14v<br>0-18v   | 80-Watt<br>100-Watt | Electronic       |
| MTH Z-4000                            | Red Terminal           | Black Terminal        | 0-22v            | 390-Watt            | Electronic       |
| Lionel 1032                           | U                      | A                     | 5-16v            | 90-Watt             | Standard         |
| Lionel 1032M                          | U                      | A                     | 5-16v            | 90-Watt             | Standard         |
| Lionel 1033                           | U                      | A                     | 5-16v            | 90-Watt             | Standard         |
| Lionel 1043                           | U                      | A                     | 5-16v            | 90-Watt             | Standard         |
| Lionel 1043M                          | U                      | A                     | 5-16v            | 90-Watt             | Standard         |
| Lionel 1044                           | U                      | A                     | 5-16v            | 90-Watt             | Standard         |
| Lionel 1053                           | U                      | A                     | 8-17v            | 60-Watt             | Standard         |
| Lionel 1063                           | U                      | A                     | 8-17v            | 60-Watt             | Standard         |
| All-Trol                              | Left Terminal          | Right Terminal        | 0-24v            | 300-Watt            | Electronic       |
| Dallee Hostler                        | Left Terminal          | Right Terminal        |                  |                     | Electronic       |
| Lionel LW                             | A                      | U                     | 8-18v            | 75-Watt             | Standard         |
| Lionel KW                             | A or B                 | U                     | 6-20v            | 190-Watt            | Standard         |
| Lionel MW                             | Outside Track Terminal | Inside Track Terminal | 5-16v            | 50V.A.              | Electronic       |
| Lionel RS-1                           | Red Terminal           | Black Terminal        | 0-18v            | 50V.A.              | Electronic       |
| Lionel RW                             | U                      | A                     | 9-19v            | 110-Watt            | Standard         |
| Lionel SW                             | U                      | A                     | Unknown          | 130-Watt            | Standard         |
| Lionel TW                             | U                      | A                     | 8-18v            | 175-Watt            | Standard         |
| Lionel ZW                             | A,B,C or D             | U                     | 8-20v            | 275-Watt            | Standard         |
| Lionel Post-War Celebration Series ZW | A,B,C or D             | Common                | 0-20v            | 135/190 Watt        | Electronic       |



# Additional Features Accessible With The DCS Remote Control System

(Additional equipment required)

While conventional mode operation of a Proto-Sound 2.0 engine yields wonderfully realistic sound and several train control features, command mode operation allows the user to access a world of command functions never before accessible to O Gauge railroaders. With the addition of the DCS Remote Control System (including a DCS remote handheld and Track Interface Unit) users gain many advanced features, including:

- DCS Proto-Speed Control - Establishes desired locomotive speed in scale miles per hour increments via a thumbwheel control and allows operator to set maximum speed and acceleration/deceleration rates
- ProtoSmoke® Variable Output Control - Controls how much smoke each engine outputs and matches smoke to locomotive speed
- Locomotive Lighting Control - Controls locomotive headlights, marker and interior lights, beacon lights, ditch lights, and MARS lights
- Emergency Stop-Single button push stops all Proto-Sound 2.0 trains but does not turn off the power
- One Touch Global Mute/UnMute-Single button mutes or unmutes all DCS-controlled locomotives' user-defined actions, including sound, lights, and smoke
- Proto-Dispatch Operation-Public Address-like feature allows users to speak through locomotive speaker during operation
- Proto-Cast-Allows users to play audio recordings through locomotive speaker during operation
- Proto-Doppler Sound Effects Set Up-Users can configure locomotive for Doppler Operation, including setting distance points for Doppler start, repeat, and stop modes
- Independent Volume Control of Engine Sounds, Bell, Horn & Whistle for each Locomotive
- Control up to 50 different DCS-Equipped Locomotives at one time with multiple TIUs
- Proto-Effects™ Set Up-User can select individual Proto-Effects™ operations to be active or inactive, including cab chatter, train wreck sounds, coupler sounds, Direction Control Set Up-User can set initial individual start-up direction (start in forward or reverse) for double-heading operations
- Locomotive Consist Set-up-User can determine locomotive values for consist make-ups, allowing multiple locomotives belonging to a consist to operate together

# Service & Warranty Information

## How to Get Service Under the Terms of the Limited One-Year Warranty

When you suspect an item is defective, please check the operator's manual for standard operation and troubleshooting techniques that may correct the problem. Additional information may be found on the M.T.H. Website. Should you still require service, follow the instructions below to obtain warranty service.

First, e-mail, write, call or fax a M.T.H. Authorized Service Center (ASC) in your area to obtain Repair Authorization. You can find the list of ASCs on the M.T.H. Website, [www.mth-railking.com](http://www.mth-railking.com). Authorized Service Centers are required to make warranty repairs on items sold *only* from that store; all other repairs may-- or may not be done at the store's own discretion. If you did not purchase the item directly from the ASC, you will need to select a National Authorized Service Center (NASC). These centers are compensated by M.T.H. to perform warranty service for any customer whose repair qualifies for warranty service. A list of NASC retailers can be located on the M.T.H. Website or by calling 1-888-640-3700. Should the warranty no longer apply, you may choose either an ASC or NASC retailer to service your M.T.H. Product. A reasonable service fee will be charged.

**CAUTION:** Make sure the product is packed in its original factory packaging including its foam and plastic wrapping material to prevent damage to the merchandise. There is no need to return the entire set if only one of the components is in need of repair *unless otherwise instructed by the Service Center*. The shipment must be prepaid and we recommend that it be insured. A cover letter including your name, address, daytime phone number, e-mail address (if available), Return Authorization number (if required by the service center, a copy of your sales receipt and a full description of the problem must be included to facilitate the repairs. Please include the description regardless of whether you discussed the problem with a service technician when contacting the Service Center for your Return Authorization.

Please make sure you have followed the instructions carefully before returning any merchandise for service. Authorized M.T.H. Service Centers are independently owned and operated and are not agents or representatives of M.T.H. Electric Trains. M.T.H. assumes no responsibility financial or otherwise, for material left in their possession, or work done, by privately owned M.T.H. Authorized Service Centers. If you need assistance at any time email MTH Service at [service@mth-railking.com](mailto:service@mth-railking.com), or call 410 381-2580.

## Limited One-Year Warranty

All M.T.H. products purchased from an Authorized M.T.H. Train Merchant are covered by this warranty.

See our website at [www.mth-railking.com](http://www.mth-railking.com) or call 1-888-640-3700 to identify an Authorized M.T.H. Train Merchant near you.

M.T.H. products are warranted for one year from the date of purchase against defects in material or workmanship, excluding wear items such as light bulbs, pick-up rollers, batteries, smoke unit wicks, and traction tires. We will repair or replace (at our option) the defective part without charge for the parts or labor, if the item is returned to an M.T.H. Authorized Service Center (ASC) or M.T.H. National Authorized Service Center (NASC) within one year of the original date of purchase. This warranty does not cover damages caused by improper care, handling, or use. Transportation costs incurred by the customer are not covered under this warranty.

Items sent for repair must be accompanied by a return authorization number, a description of the problem, and a copy of the original sales receipt from an Authorized M.T.H. Train Merchant, which gives the date of purchase. If you are sending this product to an Authorized Service Center, contact that Center for their return authorization.

This warranty gives you specific legal rights, and you may have other rights that vary from state to state. Specific questions regarding the warranty may be forwarded to M.T.H. Directly

Service Department:  
M.T.H. Electric Trains  
7020 Columbia Gateway Drive  
.Columbia MD 21046-1532



## AUTHORIZED SERVICE CENTER

7020 Columbia Gateway Dr. - Columbia, MD 21046

Information: 410-381-2580 Fax: 410-381-6122

[www.mth-railking.com](http://www.mth-railking.com)

## PARTICIPATING A.S.C. RETAILER LIST

### **ALABAMA**

SOUTHERLAND STATION  
HUNTSVILLE  
256-533-4720

### **ARIZONA**

ARIZONA TRAIN DEPOT  
MESA  
480-833-9486

### **CALIFORNIA**

CENTRAL COAST TRAINS  
ATASCADERO  
805-466-1391

TRAIN SHACK  
BURBANK  
818-842-3330

REED'S HOBBY SHOP  
LA MESA  
619-464-1672

ROUNDHOUSE  
NORTH HOLLYWOOD  
818-769-0403

DOLLHOUSES, TRAINS &  
MORE  
NOVATO  
415-883-0388

TIN PLATE JUNCTION  
OAKLAND  
510-444-4780

RON'S WORLD  
SAN CLEMENTE  
949-361-5596

BLACK NIGHT TRAINS &  
HOBBIES  
SANTA ROSA  
707-523-3522

### **COLORADO**

CUSTOM RAILWAY SUPPLY  
COLORADO SPRINGS  
719-634-4616

CABOOSE HOBBIES, INC.  
DENVER  
303-777-6766

MIZELL TRAINS  
WESTMINSTER  
303-429-4811

### **CONNECTICUT**

TIME MACHINE HOBBY, LL C  
MANCHESTER  
860-646-0610

### **FLORIDA**

AMHERST DEPOT  
ENGLEWOOD  
941-475-2020

DEPOT HOBBY SHOP  
IANTANA  
561-585-1982

HOLLYWOOD STATION  
MIAMI  
954-921-2700

READY TO ROLL  
MIAMI  
305-688-8868

COLONIAL PHOTO & HOBBY  
ORLANDO  
407-841-1485

WARRICK CUSTOM HOBBIES  
PLANTATION  
954-370-0708

ROUNDHOUSE SOUTH  
PORT ORANGE  
386-304-7002

### **ILLINOIS**

BERWYN'S TOY TRAINS &  
MODELS  
BERWYN  
708-484-4384

CHICAGOLAND HOBBY  
CHICAGO  
773-775-4848

BILL'S ENGLEWOOD STATION  
ORLAND PARK  
708-460-4906

BIKE & CHOO CHOO  
CONNECTION  
SCHAUMBURG  
847-882-7728

### **INDIANA**

Y. O. R. K. TRAINS  
MUNSTER  
219-838-9999

SAMUELSON'S TRAIN SHOP  
VALPARAISO  
219-462-2708

### **IOWA**

CABOOSE STOP HOBBIES  
CEDAR FALLS  
800-642-7012

### **KANSAS**

HOBBY HAVEN  
OVERLAND PARK  
913-381-3111

### **KENTUCKY**

L & N TRAINS & THINGS  
LOUISVILLE  
502-897-9005

**LOUISIANA**

AMERICA'S TRAIN YARD  
BATON ROUGE  
225-926-5592

**MAINE**

WHEELS, WINGS & THINGS  
LUDLOW  
207-532-6277

**MARYLAND**

HOBBYTOWN U S A  
FREDERICK  
301-694-7395

FREDERICK JUNCTION  
FREDERICK  
301-694-3434

ENGINE HOUSE HOBBIES  
GAITHERSBURG  
301-590-0816

J & B TRAINS  
HAGERSTOWN  
240-420-4930

THE TRAIN ROOM  
HAGERSTOWN  
301-745-6681

PURKEY'S TOY TRAINS  
SYKESVILLE  
410-549-6061

CATOCOTIN MOUNTAIN TRAINS  
& HOBBIES  
THURMONT  
301-694-8331

E.L. JONES & SONS  
WILLIAMSPORT  
800-810-8138

**MASSACHUSETTS**

FLYING YANKEE HOBBY  
SHOP  
BOSTON  
617-323-9702

NORTHEAST TRAINS  
PEABODY  
978-532-1615

EAST BAY HOBBIES  
SEEKONK  
508-336-5573

PIONEER VALLEY HOBBIES  
W. SPRINGFIELD  
413-732-5531

**MICHIGAN**

MICHIGAN MODEL TRAIN  
CENTER  
PINCKNEY  
734-426-1651

BRASSEUR ELECTRIC  
TRAINS INC.  
SAGINAW  
989-793-4753

**MINNESOTA**

DON'S HOBBY CO.  
MANKATO  
507-387-1330

**MISSOURI**

SWITCH STAND  
SAINT LOUIS  
314-781-4458

MARK TWAIN HOBBY CENTER  
ST. CHARLES  
636-946-2816

**NEVADA**

RENO RAILS  
RENO  
775-337-6669

**NEW HAMPSHIRE**

TREASURED TOYS  
SALEM  
603-898-7224

**NEW JERSEY**

HOBBY SHOP  
ABERDEEN  
732-583-0505

COUNTRY AND STUFF  
ANDOVER  
973-786-7086

GENE'S TRAINS  
BRICK  
732-840-9728

COLUMBUS TRAIN STATION  
COLUMBUS  
609-518-1800

ATLANTIC RAILS  
HAMMONTON  
609-567-8490

C B TRAIN DEPOT  
HILLSDALE  
201-666-9598

GRAND CENTRAL STATION  
KEARNY  
201-955-6200

J & B TRAINS, INC.  
MAPLE SHADE  
856-414-0092

HOBBYMASTERS, INC  
RED BANK  
732-842-6020

RIDGEFIELD HOBBY  
RIDGEFIELD  
201-943-2636

TOM'S MODEL TRAINS  
SCOTCH PLAINS  
908-322-6122

TRAINS & THINGS  
TRENTON  
609-883-8790

HOLLY BEACH TRAIN DEPOT  
WILDWOOD  
609-522-2379

**NEW YORK**

L B C MODEL TRAINS  
BUFFALO  
716-631-3081

KURT'S TRAINS & HOBBIES  
CALEDONIA  
585-538-2960

AURORA RAILS & HOBBIES  
EAST AURORA  
716-652-5718

NASSAU HOBBY CENTER,  
INC.  
FREEPORT  
516-378-9594

J & R JUNCTION  
LIVERPOOL  
315-451-6551

HOBBY WORLD  
MONTICELLO  
845-794-8770

CITY DEPOT, INC.  
NEW HAMPTON  
845-374-3010

THIRD STREET DEPOT  
NIAGARA FALLS  
716-285-6464

ISLAND TRAINS  
STATEN ISLAND  
718-317-0008

SCAG'S ELECTRIC TRAIN  
SHOP  
STATEN ISLAND  
718-727-7373

AMERICANA STORE  
TIVOLI  
845-757-4246

KROSS HARDWARE  
WEST BABYLON  
631-669-3069

WESTCHESTER CENTRAL  
TRAINS  
WHITE PLAINS  
914-421-1262

**NORTH CAROLINA**

THE ROUNDHOUSE &  
BACKSHOP  
CARY  
919-465-0810

DRY BRIDGE STATION  
MOUNT AIRY  
336-786-9811

THE FREIGHT YARD  
SMITHFIELD  
919-934-6229

LITTLE CHOO CHOO SHOP  
INC.  
SPENCER  
704-637-8717

TRAIN LOFT  
WINSTON-SALEM  
336-760-9817

### **OHIO**

E & S TRAINS  
AKRON  
330-745-0785

T & K HOBBY SHOP  
BRIDGEPORT  
740-633-6607

PARMA HOBBY  
CLEVELAND  
216-741-6440

SANDY'S HOBBY'S &  
COLLECTIBLES  
ELYRIA  
440-365-9999

DUNHAM'S TOY TRAINS  
LONDON  
740-852-0899

CLEARVIEW TRAIN & HOBBY  
LORAIN  
440-277-4488

DIXIE UNION STATION  
MASON  
513-459-0460

DAVIS TRAINS  
MILFORD  
1-800-448-1060

ERIE RAILWAY DEPOT  
TROY  
937-440-9922

### **PENNSYLVANIA**

AMERICAN HOBBY CENTER  
ALTIQUIPPA  
724-378-3930  
BUSSINGER TRAINS  
AMBLER  
215-628-2366

JIM'S HOBBY SERVICE  
BERWICK  
570-759-2695

YE OLDE TRAIN &  
CHRISTMAS SHOPPE  
BOYERTOWN  
610-369-0755

NICHOLAS SMITH TRAINS  
BROOMALL  
610-353-8585

CHARLEROI SWEEPER  
CENTER  
CHARLEROI  
724-483-3397

JERRY QUINN TRAINS & TOYS  
COATESVILLE  
610-383-1931

CRANBERRY HOBBY DEPOT  
CRANBERRY TWP  
724-776-3640

FAIRCHANCE PHARMACY  
FAIRCHANCE  
724-564-7817

TRAINS R FUN  
FRAZER  
610-644-4585

THE CABOOSE  
LEHIGHTON  
570-386-5352

SCHUYLKILL FLYER HOBBIES  
LEESPORT  
484-248-2100

HOBBY CITY  
McMURRAY  
724-942-2557

ENGLISH MODEL RR  
MONTOURSVILLE  
800-327-5126

STATION/M H INDUSTRIES  
NEW CUMBERLAND  
717-774-7096

FRYER'S STORE  
ORWIGSBURG  
570-366-2258

TOBY TYLER'S HOBBY  
CENTER  
PITTSBURGH  
412-653-5030

WILCOX GREENHOUSE &  
NURSERY  
TITUSVILLE  
814-827-3823

EASTERN DEPOT  
TROY  
570-297-1975

J & J RAILROAD CROSSING  
INC  
TURTLE CREEK  
412-824-6009

THE TRAIN SHOPPE & HOBBY  
CENTER LD  
WILKES BARRE  
570-824-7688

### **RHODE ISLAND**

GRANDMA'S HOUSE  
GRANDPA'S TRAIN  
WARWICK  
401-463-7803

### **SOUTH CAROLINA**

EMERALD TRAIN & HOBBY  
GREENWOOD  
864-223-2247

### **TENNESSEE**

MODEL RAILROAD & HOBBY  
SHOP  
MEMPHIS  
901-384-6500

TRAINS-N-THINGS  
PARIS  
731-641-8880

### **TEXAS**

HOBBY TIME  
AMARILLO  
806.352.9660

RIVERVIEW TRAINS  
ANGLETON  
979-848-3895

GREAT TRAINS & HOBBIES  
LONGVIEW  
903-757-2720

### **UTAH**

ALMOSTA JUNCTION  
CLEARFIELD  
801-776-1656

### **VIRGINIA**

LEESBURG HOBBIES &  
COLLECTIBLES  
LEESBURG  
703-779-8600

LOCUST GROVE TRAINS  
LOCUST GROVE  
540-854-8955

TRAINS, ETC.  
LORTON  
703-550-1779

TRAIN DEPOT  
MANASSAS  
703-335-2216

CHESTERFIELD HOBBIES  
MIDLOTHIAN  
804-379-9091

DAVIS HOBBY SUPPLIES  
PORTSMOUTH  
757-397-1983

TOY TRAIN CENTER  
RICHMOND  
804-288-4475

T S G HOBBIES  
WARRENTON  
540-347-9212

NORGE STATION  
WILLIAMSBURG  
757-564-7623

**WASHINGTON**  
EASTSIDE TRAINS  
KIRKLAND  
425-828-4098

**WEST VIRGINIA**  
PATRICK'S TRAINS  
WHEELING  
304-232-0714

**WISCONSIN**  
WOODCRAFTERS SHOP  
BURLINGTON  
262-763-5239

SOMMERFELD'S TRAINS  
BUTLER  
262-783-7797  
HOBBY OUTLET  
FOND DU LAC  
920-924-3770

G B T V & TRAINS  
GREEN BAY  
920-496-9697

GRAMPA'S TRAIN SHOP  
RICE LAKE  
715-234-2996

**CANADA**  
TOY TRAIN WORKSHOP  
CUMBERLAND  
613-833-8331

THE TRAIN ROOM  
FERGUS  
19-787-3280

CREDIT VALLEY RAILWAY  
COMPANY  
TREETSVILLE  
905-826-1306

B&H TRAINS  
TERREBONNE  
514-793-9696

## PARTICIPATING N.A.S.C. LIST

**CALIFORNIA**  
TIN PLATE JUNCTION  
OAKLAND  
510-444-4780

**COLORADO**  
MIZELL TRAINS  
WESTMINSTER  
303-429-4811

**CONNECTICUT**  
TIME MACHINE HOBBY, LL C  
MANCHESTER  
860-646-0610

**FLORIDA**  
COLONIAL PHOTO & HOBBY  
ORLANDO  
407-841-1485

ROUNDHOUSE SOUTH  
PORT ORANGE  
386-304-7002

**ILLINOIS**  
CHICAGOLAND HOBBY  
CHICAGO  
773-775-4848

**KENTUCKY**  
L&N TRAINS & THINGS  
LOUISVILLE  
502-897-9005

**MARYLAND**  
ENGINE HOUSE HOBBIES  
GAITHERSBURG  
301-590-0816

CATOCTIN MOUNTAIN TRAINS  
& HOBBIES  
THURMONT  
301-694-8331

**MICHIGAN**  
MICHIGAN MODEL TRAINS  
PINCKNEY  
734-426-1651

BRASSEUR ELEC. TRAINS  
SAGINAW  
989-793-4753

**NEW HAMPSHIRE**  
TREASURED TOYS  
SALEM  
603-898-7224

**NEW YORK**  
L B C MODEL TRAINS  
BUFFALO  
716-631-3081

AURORA RAILS & HOBBIES  
EAST AURORA  
716-652-5718

THIRD STREET DEPOT  
NIAGARA FALLS  
716-285-6464

**OHIO**  
DAVIS TRAINS  
MILFORD  
1-800-448-1060

**PENNSYLVANIA**  
BUSSINGER TRAINS  
AMBLER  
215-628-2366

JIM'S HOBBY SERVICE  
BERWICK  
570-759-2695

FAIRCHANCE PHARMACY  
FAIRCHANCE  
724-564-7817

ENGLISH MODEL RR  
MONTOURSVILLE  
800-327-5126

TOBY TYLER'S HOBBY CEN.  
PITTSBURGH  
412-653-5030

**VIRGINIA**  
LOCUST GROVE TRAINS  
LOCUST GROVE  
540-854-8955

DAVIS HOBBY SUPPLIES  
PORTSMOUTH  
757-397-1983

T S G HOBBIES  
WARRENTON  
540-347-9212

**WISCONSIN**  
SOMMERFELD'S TRAINS  
BUTLER  
262-783-7797

GRAMPA'S TRAIN SHOP  
RICE LAKE  
715-234-2996

**CANADA**  
TOY TRAIN WORKSHOP  
CUMBERLAND  
13-833-8331

THE TRAIN ROOM  
FERGUS  
519-787-3280